



HOKANDARA

RESERVED FOR THE FEW
WHO BUILD THEIR OWN SUCCESS.

A COMMUNITY YOU QUALIFY FOR.



GRAND ENTRANCE

A STATEMENT OF PRIVILEGE.

Every detail at ISLA is designed to reflect exclusivity, security and refined living.

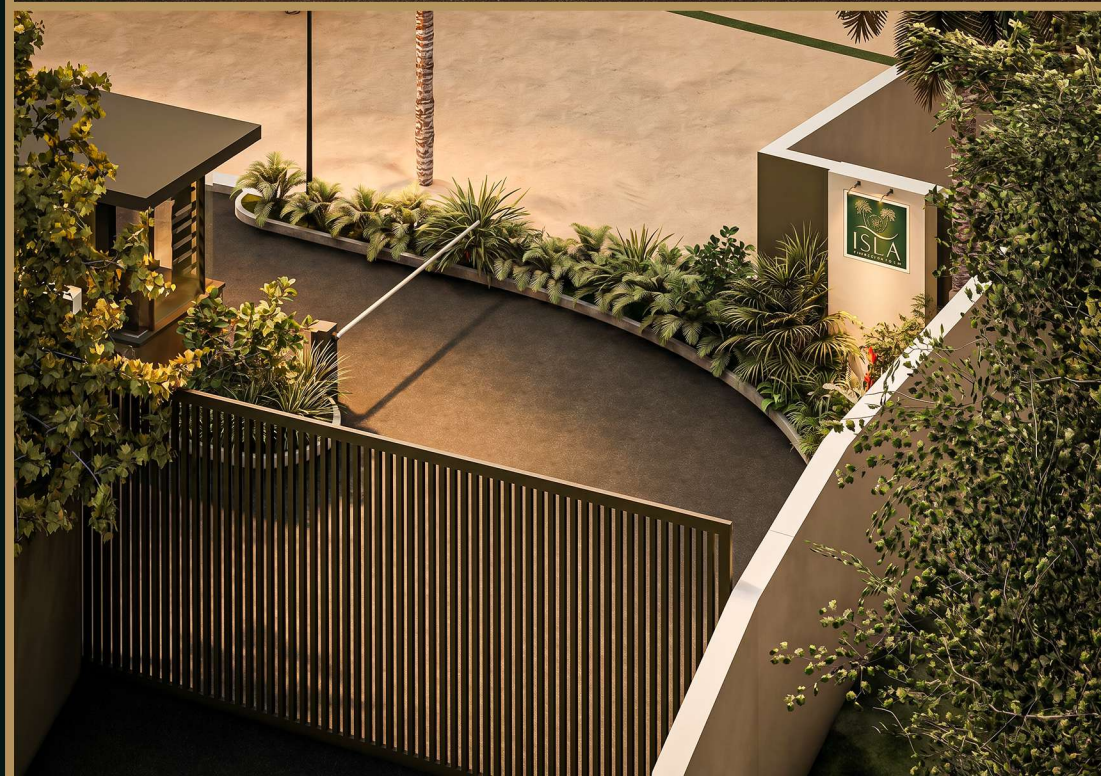



YOUR LEGACY YOUR SPACE

You've built everything.
Now build a space that
reflects who you've
become.

LAND SALE PRICE

STARTING FROM

LKR 1.8 MILLION

PER PERCH

Where luxury meets opportunity,
invest in a premium address designed for elevated living.



SECURE GATED
COMMUNITY



LANDSCAPED
AVENUES



30FT WIDE CARPET
ACCESS ROADS



HOKANDARA -
CONVENIENCE AT EVERY TURN

MASTERPLAN FOR TOMORROW

Thoughtfully planned plots,
wide access roads, lush
landscapes and future-ready
infrastructure - built to
grow in value and legacy.

PLOT SIZES

06+
PERCHES

TOTAL PLOTS

30
UNITS





SMART INVESTMENT STRONG RETURNS



CLEAR TITLE
VERIFIED WITH
APPROVED PLANS



30%
PROJECTED ANNUAL
APPRECIATION



CONNECTIVITY
STRATEGIC
LOCATION

Strategically located in a rapidly developing corridor with rising infrastructure growth and long-term value appreciation.













FIRST TIME IN SOUTH ASIA

AWARD WINNER FOR LAND INVESTMENTS

Groundworth proudly received the
Asia Property Awards (Sri Lanka) 2025
Special Recognition for Land Investments
a milestone achievement that sets a new
benchmark for the land development industry
in South Asia.

This recognition reflects our commitment to
creating exceptional investment opportunities,
premium communities and enduring value for
generations to come.

PropertyGuru
Asia Property Awards (Sri Lanka) 2025
Special Recognition for Land Investments
Groundworth (Pvt) Ltd



PropertyGuru
Asia Property Awards

OUR VISION

To redefine real estate as the foundation of enduring prosperity, where land is not just owned, but grown into **legacy**.

OUR MISSION

To empower individuals and communities to build resilient real estate portfolios that drive **growth**, preserve **value** and shape lasting **impact** across generations.



Groundworth

GROUNDS FOR GROWTH

 groundworthgroup.com  sales@groundworthgroup.com  **0777 450 050**

1112/3A, Level 03, Hasthanayake Building, Pannipitiya Road, Thalangama, Battaramulla

Isla: No 15/10, Bastian Weragala Mawatha, Hokandara North, Hokandara



Get Directions

Note: The visuals, architectural impressions and illustrations presented in this document are for reference purposes only and may vary from the final delivered outcome.